



Made to get the ideal CLIMATE for any season



Refrigerated Water Packaged Air-conditioners

CED 8kW_37kW Series

Displacement_Conventional_Underfloor_High-Front



Indoor packaged Air-conditioners with finned water heat exchanger, ideal for installations in rooms, equipment rooms, DPC and technological rooms in general.

The pre-galvanised steel structure painted with epoxy powder paint, is supported by a thick internal structure. The panels are supplied with sound-absorbent and isolating material.

The structure is realised with single or double doors, depending on cooling capacity requested.

- The refrigerated water air-conditioners can be equipped:
- without free-cooling system (AR vers.)
 - with free-cooling system (AF vers.)

The process air can be carried in different ways:

- **from the low horizontal to displacement (DISPLACEMENT)**
 - Air return at the top (roof), flow down the front, low speed
- **from the low horizontal (CONVENTIONAL)**
 - High air return (at the roof), front delivery
- **towards the low vertical (UNDERFLOOR)**
 - High air return (at the roof), delivery low underfloor
- **upwards (HIGH-FRONT)****
 - Air return from low front, delivery upwards (roof)

The air-conditioners are supplied with internal controller, temperature probes and flow switch, which allow to realise an autonomous and co-ordinated "air-conditioning system" thus ensuring complete redundancy on all of the control and air-conditioning functions.

The machine is also supplied with the User Interface Panel on the machine for command and control management.

The water-cooled air-conditioners are supplied with process air filter and condensate collection tray; 3-way valve with proportional control for management of the water flow in the coil. Moreover, they are characterised by maximum accessibility and strength.

The water-cooled air-conditioner line includes various powers that go from 8 ÷ 37 kW

** On specific request



Typical DPC with two doors

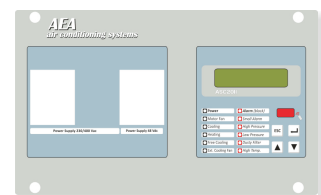

P Series user interface panel

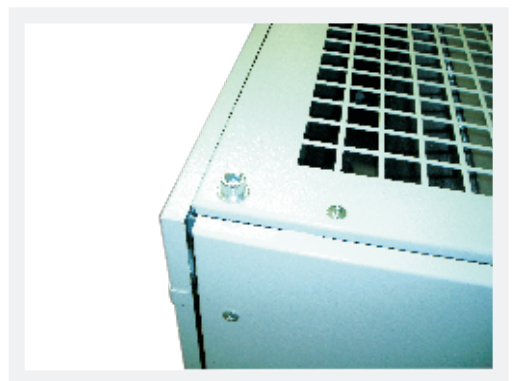

Technical features

- Support structure and external panels in galvanised steel
- High resistance to corrosion
- Command and control board with user interface panel on the machine
- Automatic re-start after a power cut
- Air handling section 230Vac (48 Vdc on request)





Operating Mode

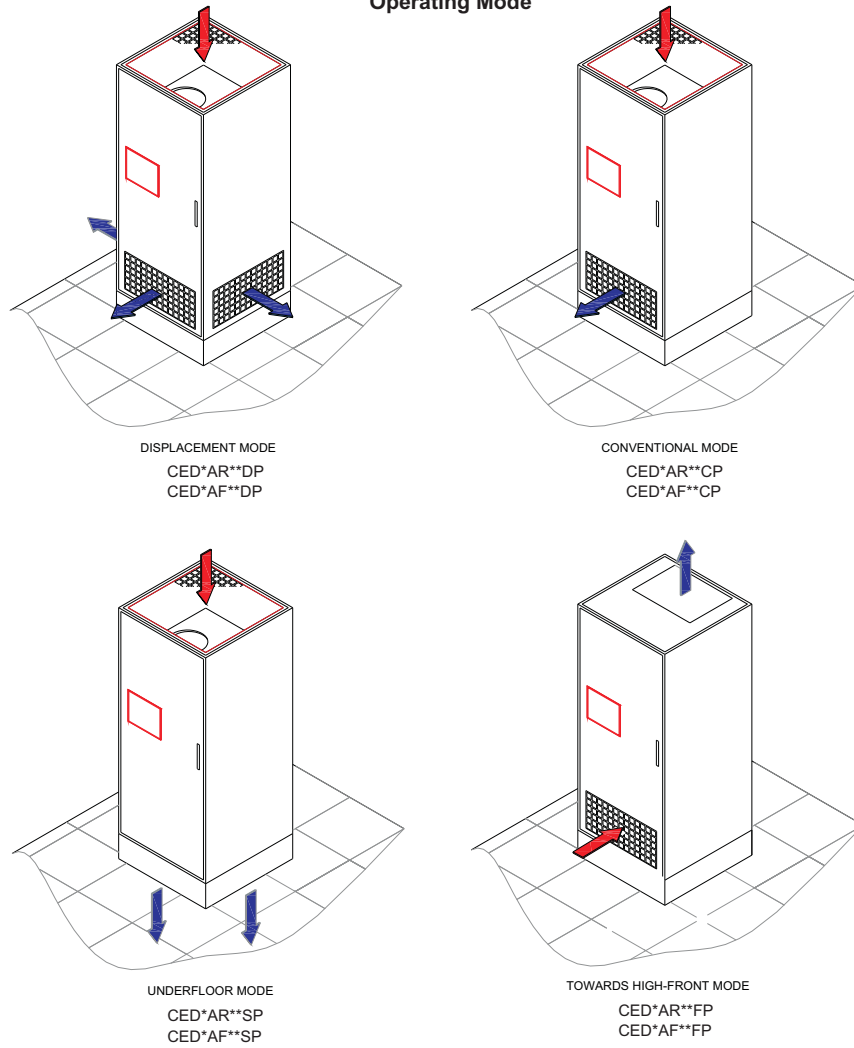

(*) Indicate the machine power

Model		80	120	170	210	240	280	330	370
Cooling capacity									
Total 1	W	8000	12000	17500	21000	24500	28500	33500	38000
Sensitive 1	W	5500	9000	11000	13000	14500	17500	20500	23000
Total 2	W	6100	9200	13500	16200	19300	22000	25800	29300
Sensitive 2	W	4500	7200	9900	11800	13000	15100	17000	20800
Total 3	W	5400	8100	11900	14300	17000	19400	22800	25900
Sensitive 3	W	4100	6600	8800	9700	11200	13200	15100	17600
Process fans features									
Air flow rate	m ³ /h	1700	2200	2200	4500	4500	4500	4500	4500
Electric features									
Power supply voltage	V / Hz	230 / 50							
Absorbed power	Kw	0.31	0.31	0.31	0.6	0.6	0.6	0.6	0.6
Dimensions and weights									
Width	mm	600 (1 room)	600 (1 room)	800 (1 room)	1200 (2 rooms)	1200 (2 rooms)	1600 (2 rooms)	1600 (2 rooms)	1600 (2 rooms)
Depth	mm	800	800	800	800	800	800	800	800
Height	mm	1900	1900	1900	1900	1900	1900	1900	1900
Weight (indicative)	Kg	165	165	225	310	310	375	375	375

1 - Input air 31°C - 45%RH
2 - Input air 26°C - 45%RH
3 - Input air 24°C - 45%RH

Operating limits: environment air from 20°C to 37°C
Reference conditions: water 9/13 °C - glycol 0%





AEA air conditionig systems srl

Sede legale: Loc Colle,91/A - 06056 Massa Martana (Pg) - Italy

Sede amministrativa: Via dell'Artigianato,12 - 06056 Massa Martana (Pg) - Italy

Tel. +39 075.889081 - Fax +39 075.88908215

e-mail: aea@aeasrl.it - web: www.aeasrl.it

